



RATNAMANI INTERNATIONAL

(House of Fasteners & Turned Components)

447/1, GIDC, Sanker Tekri, Udyog Nagar, Jamnagar, Gujarat, INDIA

www.ratnamaniinternational.com Email : Info@ratnamaniinternational.com

DIN – 913 Hexagon socket set screws with flat point

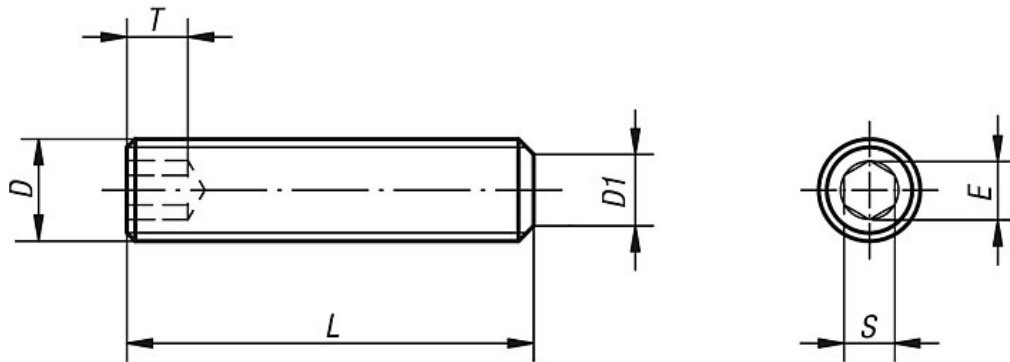

Customer Information Sheet (For Reference Only)

Dimensions in MM

Nominal Dia	Pitch	(s)			(d1)		(e)	(t)
		Nom.	Min	Max	Min	Max	Min	Min
2MM	0.40	0.90	0.889	0.902	0.75	1.00	1.003	0.80
2.5MM	0.45	1.30	1.27	1.295	1.25	1.50	1.427	1.20
3MM	0.50	1.50	1.52	1.545	1.75	2.00	1.73	1.20
4MM	0.70	2.00	2.02	2.045	2.25	2.50	2.30	1.5
5MM	0.80	2.50	2.52	2.560	3.20	3.50	2.87	2.00
6MM	1.00	3.00	3.02	3.08	3.70	4.00	3.44	2.00
8MM	1.25	4.00	4.02	4.095	5.52	5.50	4.58	3.00
10MM	1.50	5.00	5.02	5.095	6.64	7.00	5.72	4.00
12MM	1.75	6.00	6.02	6.095	8.14	8.50	6.86	4.80
14MM	2.00	6.00	6.02	6.095	9.64	10.00	6.86	5.60
16MM	2.00	8.00	8.025	8.115	11.57	12.00	9.15	6.40
18MM	2.50	10.00	10.025	10.115	12.57	13.00	11.43	7.20
20MM	2.50	10.00	10.025	10.115	14.57	15.00	11.43	8.00